

# Naming Opportunities

Create a lasting legacy for yourself, your family or your business by underwriting a portion of the Old Mill Center expansion project. All donors will be permanently recognized with brass plaques in the sponsored area.

West Wing, East Wing or South Wing	\$1,000,000 each
Education and Conference Center	\$500,000
Occupational and Physical Therapy Center	\$250,000
Pre-School and Intensive Treatment Classrooms	\$100,000
Outdoor Covered Play Area	\$100,000
Library or Resource Center or Reception Area	\$50,000
Outpatient Counseling and Professional Offices	\$25,000
Administrative Offices	\$10,000
Parking Spaces or Restrooms	\$5,000



## Donor Gift Information

Name \_\_\_\_\_ Home phone \_\_\_\_\_  
 Address \_\_\_\_\_ Business phone \_\_\_\_\_  
 City \_\_\_\_\_ State \_\_\_\_ Zip \_\_\_\_\_ Fax \_\_\_\_\_  
 Email \_\_\_\_\_

Gift value: \$ \_\_\_\_\_  Check  Card  Pledge  In-Kind  Other  
 I plan to pay this today by:  Check  VISA  Mastercard  Other  
 VISA/MC/other # \_\_\_\_\_ Expiration date \_\_\_\_\_  
 Pledge amount: \$ \_\_\_\_\_ 1, 2, or 3 years (please circle) Beginning date \_\_\_\_\_

In-Kind Description: \_\_\_\_\_  
 Other: \_\_\_\_\_  
 Naming opportunity area selected \_\_\_\_\_  
 Area dedicated to \_\_\_\_\_



Donor Signature

\_\_\_\_\_  
 Signature Date

(Please return completed forms to Old Mill Center, 4515 SW Country Club Drive, Corvallis, OR 97333)

# Old Mill Center for Children and Families Sustainability Strategy for Expansion

Previously, our limited space was prioritized for contract-designated families, which were overwhelmingly low income with no insurance or Oregon Health Plan insurance. The additional space will allow Old Mill to increase services to families utilizing private insurance and other non-state supported funding. Operational sustainability has been addressed by providing space to 1) accommodate more clients and implement new programs; and 2) be proactive in meeting the regions unmet service needs and in meeting needs as they are identified. A Five Year Program Plan 2003-2008 served as the primary tool in the development and planning of the facility expansion.

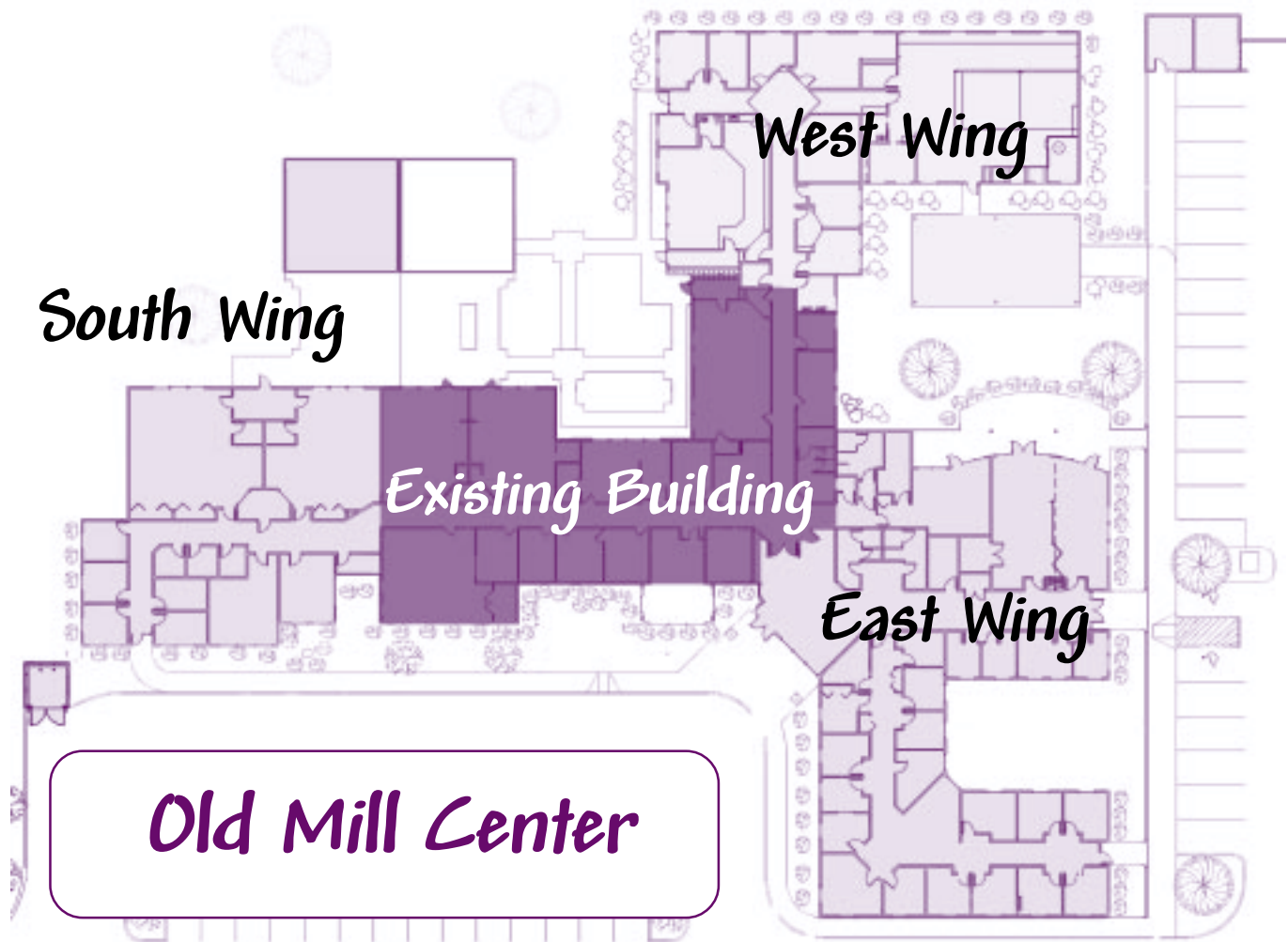

## West Wing

**OT/PT/Speech Therapy \$1,235,000\***

The OT/PT/Speech wing was selected for expansion first due to its potential to be largely self-supporting. A waiting list for services exists, although no marketing plan has ever been implemented. A day treatment classroom for children ages 6-9 with emotional disorders is also included.

**\*Includes Construction Costs and Endowment**

## East Wing

**Mental Health \$1,508,000\***

The mental health wing also has positive revenue potential and a waiting list. A conference room and library will provide flexible conference space to accommodate training for community childcare, mental health and social service professionals, and parent education and support groups. Contracts for services can be implemented for mediation, home studies, comprehensive assessment and evaluations of children, and expanded psychiatric services.

## South Wing

**Classrooms \$968,000\***

The construction of the classroom wing will coordinate with the expansion and state funding of services to young children, and a care program for high-risk infants and toddlers. The classroom space will also accommodate gaps in local services to infants and toddlers.

**Total Campaign Goal: \$4,200,000**